

The Taylor County area and the Medford-Park Falls Ranger District of the Chequamegon-Nicolet National Forest offer many bird-watching opportunities. Waterfowl and shorebirds are attracted to flowages, especially during migration. Marsh and swamp dwellers nest in the many wetlands in the area. Warblers, vireos, tanagers, hawks, and owls are attracted to a variety of upland habitats.

County, town, and Forest Service roads provide access, and most sites have convenient parking areas. Please be aware of your location and know which roads are open to motorized travel.

The Chequamegon Bird Club has promoted birding and bird conservation in North Central Wisconsin for over twenty-five years. The club was founded by well-known Wisconsin ornithologist, Sam Robbins. Go to the CBC website (www.chequamegonbirdclub.org) for additional information about the sites in this booklet or to access an interactive map.

Some of the sites are also in the Great Wisconsin Birding and Nature Trails booklets and at www.wisconsinbirds.org/trail.

BIRDING HOTSPOTS



*covering
selected areas
in*

**Taylor, Marathon, and
Clark Counties**

and

**Chequamegon-Nicolet
National Forest**



The singing thrush fills my soul with joy ;
the soaring hawk lifts my spirit high.
The tiny hummingbird, the majestic crane
- birds are awe and wonder and delight.

-CM

Birding Hotspots of North Central Wisconsin is a project of the Chequamegon Bird Club, with funding from the USDA Forest Service. It includes birding areas in the Medford-Park Falls Ranger District of the Chequamegon-Nicolet National Forest and in Taylor, Marathon, and Clark Counties.

CONTENTS

AREA MAP p. 8-9

Taylor County

| | |
|---------------------------------------|-------|
| Chequamegon-Nicolet National Forest | |
| Chequamegon Waters Flowage | p. 3 |
| Kidrick Swamp | p. 4 |
| Mondeaux Flowage | p. 5 |
| Steve Creek Flowage | p. 6 |
| Pershing Wildlife Area | p. 7 |
| Rib Lake & Gerstberger Pines | p. 10 |
| Medford Millpond & Riverwalk | p. 11 |
| Diamond Lake State Natural Area | p. 12 |
| Ice Age Trail | p. 13 |

Marathon County

| | |
|------------------------------------|-------|
| McMillan Marsh Wildlife Area | p. 14 |
|------------------------------------|-------|

Clark County

| | |
|------------------------|-------|
| Sportsman's Lake | p. 15 |
|------------------------|-------|

Many birds listed are in this area only during breeding season or migration season. Check a field guide, the Wisconsin Birds Checklist, or the Chequamegon-Nicolet NF Checklist.

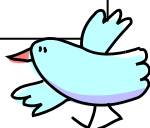

Please be a responsible birder.

- 🦅 Do not disturb nesting birds.
- 🦅 Limit use of electronic calls and pishing.
- 🦅 Do not pursue birds for a closer look or better photo.
- 🦅 Your vehicle often makes a good blind and will lessen your impact on bird activity.
- 🦅 Carry out your trash.
- 🦅 Many public lands have private inholdings. Please do not trespass.

Sportsman's Lake

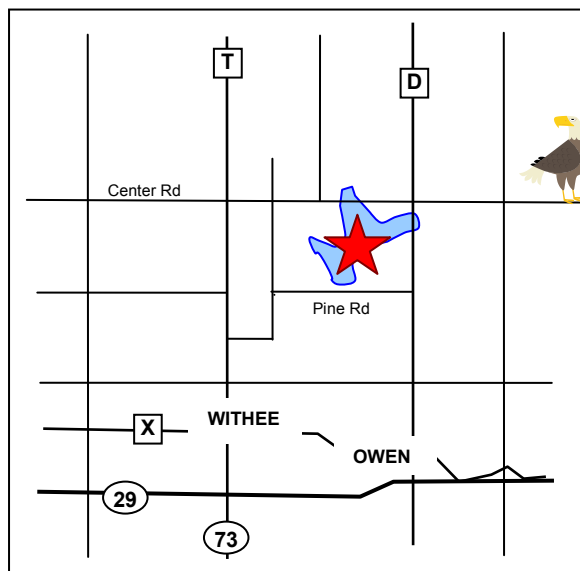

Location: West of County Rd D in Clark County. North of Owen-Withee. T29N R2W Section 24; 44° 58' N, 90° 34' W

Site is owned by Clark County and managed by the Clark County Land Conservation Dept. (715-743-5102).

Habitats: Flowage, wetland

Likely Species: Bald Eagle, Osprey, Common Loon, mergansers, Bufflehead, Ring-necked Duck, herons

Birding Tips: The dike on the south side of the flowage makes a good viewing point. Also check ponded areas on both sides of the County Rd D bridge and the stream that comes out of the flowage. Eagles have been nesting either on the flowage or on the north side of Center Rd.

Other Features: The managed area extends a mile east of County Rd D. Check this area for lowland birds.

McMillan Marsh State Wildlife Area

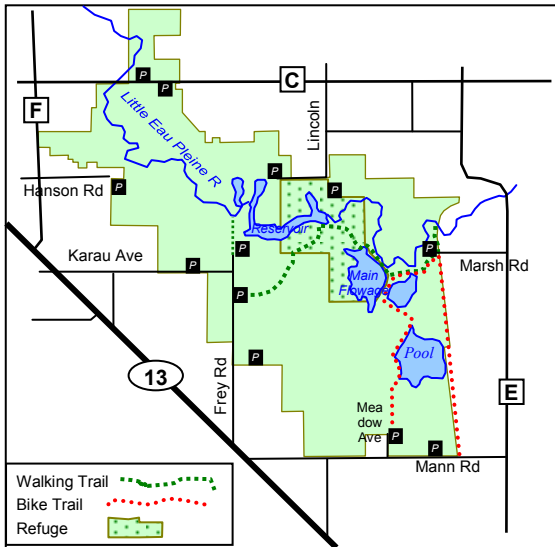

Location: Located east of Spencer and north of Marshfield near the headwaters of the Little Eau Pleine River in Marathon County. T26N R2-3E; 44° 43' N, 90° 11' W

Site is owned by Wisconsin DNR (715-457-6771).
Website: http://dnr.wi.gov/org/land/wildlife/wildlife_areas/mcmillan.htm

Habitats: Wetlands, woodlands, grasslands

Likely Species: Yellow-headed Blackbird, Least Bittern, American Bittern, Green Heron, Sedge Wren, Sandhill Crane, Whooping Crane, Black Tern, Bald Eagle, Northern Harrier, warblers, waterfowl

Birding Tips: Observations of bird species on the Little Eau Pleine Reservoir can be made from trails that are accessible from the parking lots at the ends of Frey and Lincoln Rds. The walking trails throughout McMillan provide opportunities to listen and look for many bird species

Other Features: 6,500 acres; seasonal bike trail; hiking trail. Mead Wildlife Area is about ten miles east. McMillan, Mead, and Sportsman's Lake all lie within the proposed Central Wisconsin Grassland Conservation Area, designated for Prairie Chickens and other grassland species.

Chequamegon Waters Flowage

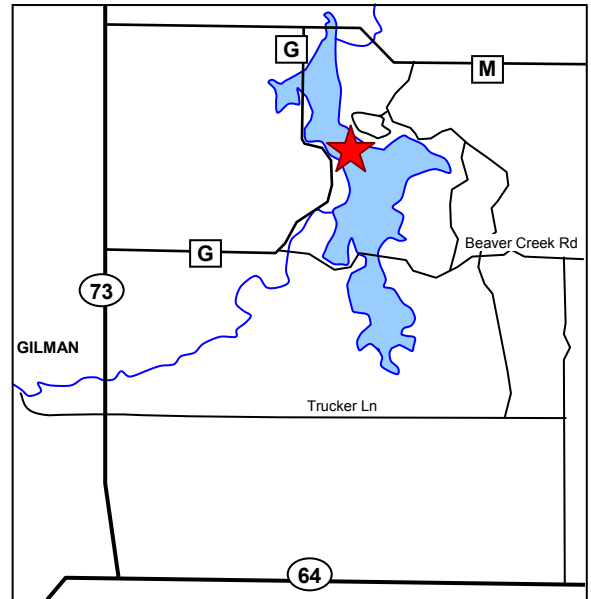

Location & Access: 6 miles northeast of Gilman. South of County Road M; east of County Road G; Beaver Creek Rd (Forest Road 121) crosses the flowage. T31N R3W Sections 1,2,11-14 and T32N R3W Sections 26,27,35,36; 45° 12' N, 90° 41' W

Site is owned by USDA Forest Service (715-748-4875) and Taylor County.
Website: www.fs.fed.us/r9/cnnf

Habitats: Flowage, wetland, mixed forest

Likely Species: Bald Eagle, Osprey, Tundra Swan (migration), Common Loon, mergansers, Bufflehead, Ring-necked Duck, herons

Birding Tips: Check bays along County Rd G and Beaver Creek Rd. Birding from a canoe gives additional access. A viewing platform is located at the end of a trail from the parking lot on Beaver Creek Rd. There is also an Osprey platform in that area.

Other Features: Restrooms, viewing platform, trails. Campgrounds and picnic facilities in area; boat ramps; fishing; mink, otter, muskrat. Known locally as Miller Dam.

Kidrick Swamp

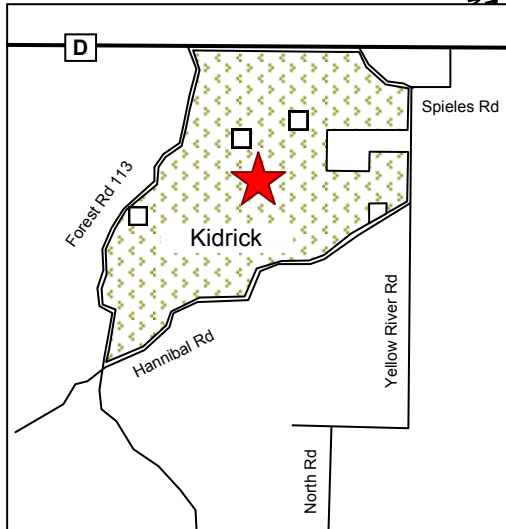

Location & Access: 6 miles east of Jump River, south of County Rd D, east of FR 113, north of Hannibal Rd. T33N R2W Sections 15-17, 20-22, 28-32; 45° 19' N, 90° 38' W.

Site is owned by USDA Forest Service (715-748-4875).

Website: www.fs.fed.us/r9/cnnf

Additional information at www.dnr.state.wi.us/org/land/er/sna/index.asp?SNA=464

There are private inholdings in this area. Please do not trespass.

Habitats: Black spruce and tamarack bog, black spruce muskeg, upland hardwoods

Likely Species: Breeding birds of special interest include Yellow-Bellied Flycatcher and Golden-Winged Warbler. Other species include Wood Duck, Alder Flycatcher, Sedge Wren, Veery, Hermit Thrush, Mourning Warbler, Nashville Warbler, Ovenbird, Rose-Breasted Grosbeak, White-Throated Sparrow, Lincoln's Sparrow

Birding Tips: Be prepared for wet feet.

Other Features: Kidrick Swamp is also a State Natural Area. There are no established trails, and the swamp is not easily visible from the road. Take map & compass. Park along road.

Ice Age National Scenic Trail

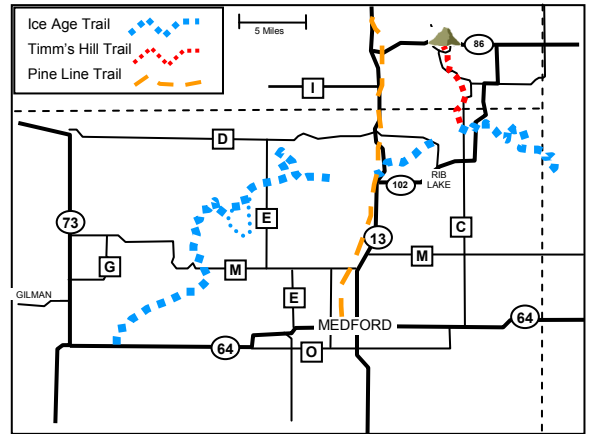

Location: Part of a state-wide trail that crosses Taylor County. Multiple access points are provided at road crossings and at National Forest and County Forest recreation sites.

The trail traverses property owned by USDA Forest Service (715-748-4875), Taylor County, Rib Lake School District, and private landowners.

Website: <http://iceagetrail.org>

Habitats: Wide variety of habitats

Likely Species: Broad-winged Hawk, Black-throated Green Warbler, Ovenbird, Bald Eagle, other woodland birds including warblers, thrushes, hawks.

Birding Tips: Check lakes and flowages for waterfowl and shorebirds. Because the trail crosses a wide variety of habitats, there are opportunities to see many species of birds.

Other Features: Also see Mondeaux Flowage. There are 68.5 miles of Ice Age Trail in Taylor County. The trail crosses private property; be sure to observe regulations and guidelines. Two side trails may also be of interest: the Timm's Hill Trail to the north and an interpretive loop west of County Rd E. The Pine Line Trail, which runs from Medford to Prentice and is open for biking and walking, offers additional birding.

Diamond Lake State Natural Area

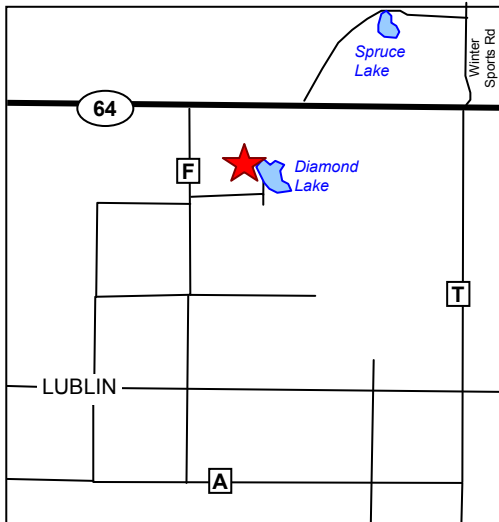

Location: 6 miles southeast of Gilman. South of State Hwy 64 off County Road F. T30N R2W, Section 6. T30N R3W, Section 1; 45° 6' N, 90° 41' W.

Site is owned Wisconsin DNR (715-532-4369) and Taylor County.

Website: www.dnr.state.wi.us/org/land/er/sna/index.asp?SNA=339

Habitats: Lake, wetland, mixed forest, old fields

Likely Species: Warblers, especially during migration; herons; Eastern Bluebird

Birding Tips: The Chequamegon Bird Club maintains a Bluebird Trail in the area.

Other Features: Restrooms, picnic facilities; boat ramp; fishing

In the Area: Check out Spruce Lake, northeast of Diamond Lake and just north of State Hwy 64 and also the Gilman School Forest Trails at the wayside on Hwy. 64, 3 miles west of County Rd F for more woodland birds.

Mondeaux Flowage

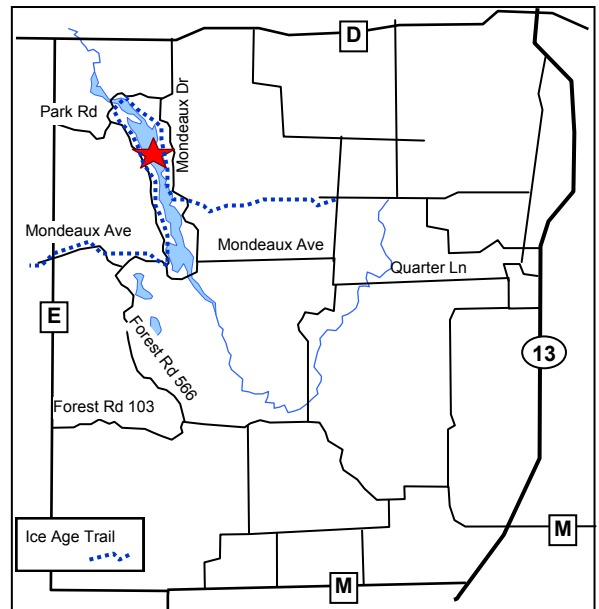

Location & Access: 12 miles northwest of Medford. South of County Rd D, north of County Road M, east of County Rd E. T33N R1W Sections 24, 25; T33N, R 1E Section 31; 45°18' N, 90°26' W.

Site is owned by USDA Forest Service (715-748-4875). Website: www.fs.fed.us/r9/cnrf

Habitats: Flowage, wetland, mixed forest

Likely Species: Great Blue Heron, Bald Eagle, Northern Parula, waterfowl

Birding Tips: Trails around the flowage, including the Ice Age Trail, provide good birding opportunities. Birding from a canoe gives additional access.

Other Features: Restrooms, trails, campgrounds, picnic facilities, boat ramps, and restaurant (April-November). Some parking and picnic areas are federal fee areas. Fishing. Other wildlife includes mink, otter, muskrat.

Steve Creek Flowage

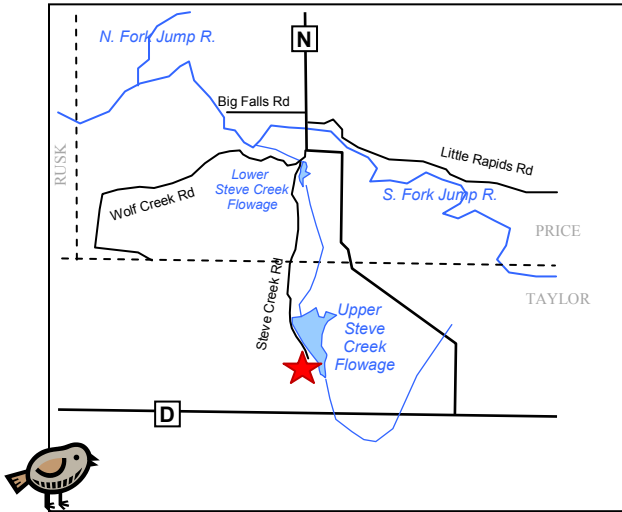

Location & Access: The Upper Steve Creek Flowage is located about 25 miles west/northwest of Medford. Access from County Rd N in Price County. From County Rd N, turn south on Wolf Creek Rd. In about ½ mile, turn south on Steve Creek Rd. The sign for the road may be partially obscured by vegetation. Steve Creek Road is a dead end. T33N R2W Sections 3, 4, and 10 in Taylor County. 45° 22' N, 90° 37' W

Site is owned by USDA Forest Service (715-748-4875).
Website: www.fs.fed.us/r9/cnnf

Habitats: Flowage, wetland, mixed forest

Likely Species: Waterfowl – especially good during migration, Common Loon, Bald Eagles. Look for woodland birds in the surrounding uplands.

Birding Tips: Also check Lower Steve Creek Flowage in Price County, which you pass on the way to the Upper Flowage. For woodland birds you may want to drive to the end of Wolf Creek Rd, which is a dead end. A hike along the South Fork Jump River often yields a variety of birds, especially during the spring migration.

Other Features: Nearby Big Falls County Park has picnicking and camping facilities, as well as a pretty waterfall.

Medford Millpond & Riverwalk

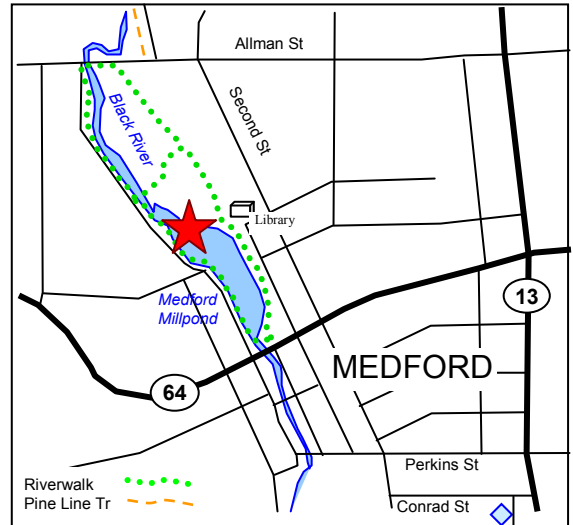

Location: Along the Black River in the City of Medford, north of State Hwy 64 (Broadway Street). The wooded portion of the Riverwalk can be accessed from the west side of the river via a pedestrian bridge or from the east side north of the library.

T31N R1E Section 27; 45° 8' N, 90° 20' W

Site is owned by the City of Medford.

Habitats: Flowage, stream, & mixed hardwoods.

Likely Species: Waterfowl on the Millpond and northern warblers in the woods and along the shores during spring and fall migration. A variety of woodland birds nest here.

Birding Tips: Take time to walk the trail, especially through the woods on the east side of the river. Also check downstream along the river below the Millpond and north of Allman St along the Pine Line Trail. The Campus Woods Trail (◇) on the south end of Donald St, 1 block west of Highway 13 and south of Conrad St, is another excellent site for woodland birds.

Other Features: Restrooms, trail, campground and picnic facilities. Fishing.



Rib Lake Area

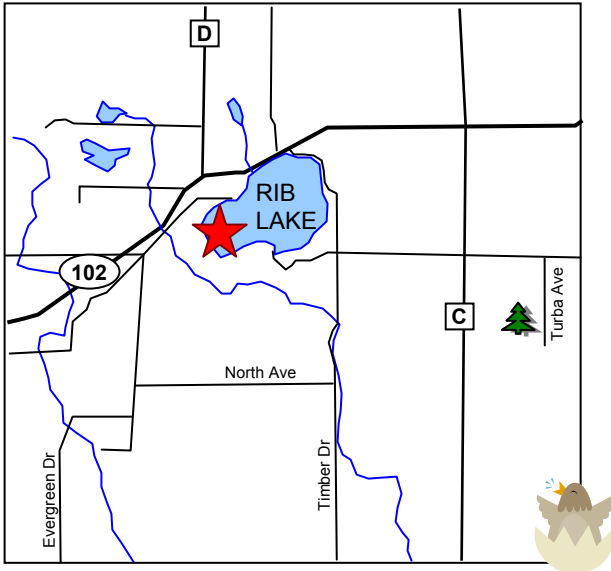

Location: In the Village of Rib Lake, 16 miles northeast of Medford. T33N R2E Section 26; 45° 18' N, 90° 11' W

Site is owned by the Village of Rib Lake and private landowners.

Habitats: Lake, streams, wetland; old growth forest.

Likely species: Bald Eagle, Osprey, Tundra Swan (migration), variety of waterfowl in early spring, wetland birds.

Birding Tips: Ospreys often nest on top of the ballpark lights on the north side of Hwy. 102 in the Village of Rib Lake. Check the pond on the north end of Tannery Creek, which flows into Rib Lake near Camp 28. Walk the trail that follows the southwest side of the lake.

Also visit Gerstberger Pines,  located about 2 miles southeast of Rib Lake (½ mile east of Hwy C on Fawn Ave to Turba Rd and south to the site). This 80 acre old growth forest, owned by Taylor County, is a good place to see woodland birds.

Other Features: A trail circles most of the lake. Village campground. Public fishing piers.

Pershing State Wildlife Area

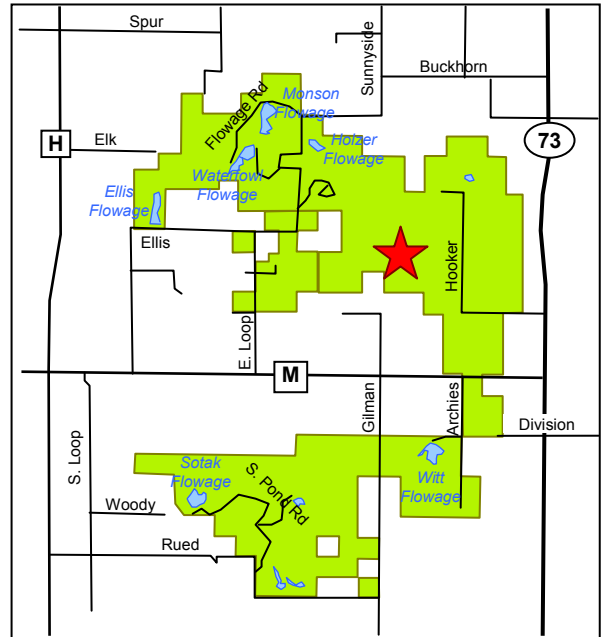

Location: 6 miles north of Gilman, west of State Hwy. 73. T32-33N R3-4W; 45° 16' N, 90° 49' W

Site is owned by Wisconsin DNR (715-532-4369).

Website: www.dnr.state.wi.us/org/land/wildlife/wildlife_areas/pershing.htm

Habitats: The project encompasses over 1,000 acres of wetlands, including 15 flowages, runoff ponds and potholes. Approximately 4,000 acres of brush-prairie is managed (in conjunction with the wetlands) through periodic rotations of prescribed burning. The remaining 3,000 acres is managed in scattered blocks of aspen and northern swamp hardwood forest.

Likely Species: Sharp-tailed grouse, especially in April. Shorebirds, waterfowl, woodcock, snipe, sparrows, raptors, many others.

Birding Tips: One nice walk is along the dike on the Witt Flowage. Blinds are available in spring to watch Sharp-tailed Grouse displaying. Call DNR to reserve.

Other Features: Campgrounds at near-by Chequamegon-Nicolet National Forest and in Village of Gilman.



AREA MAP

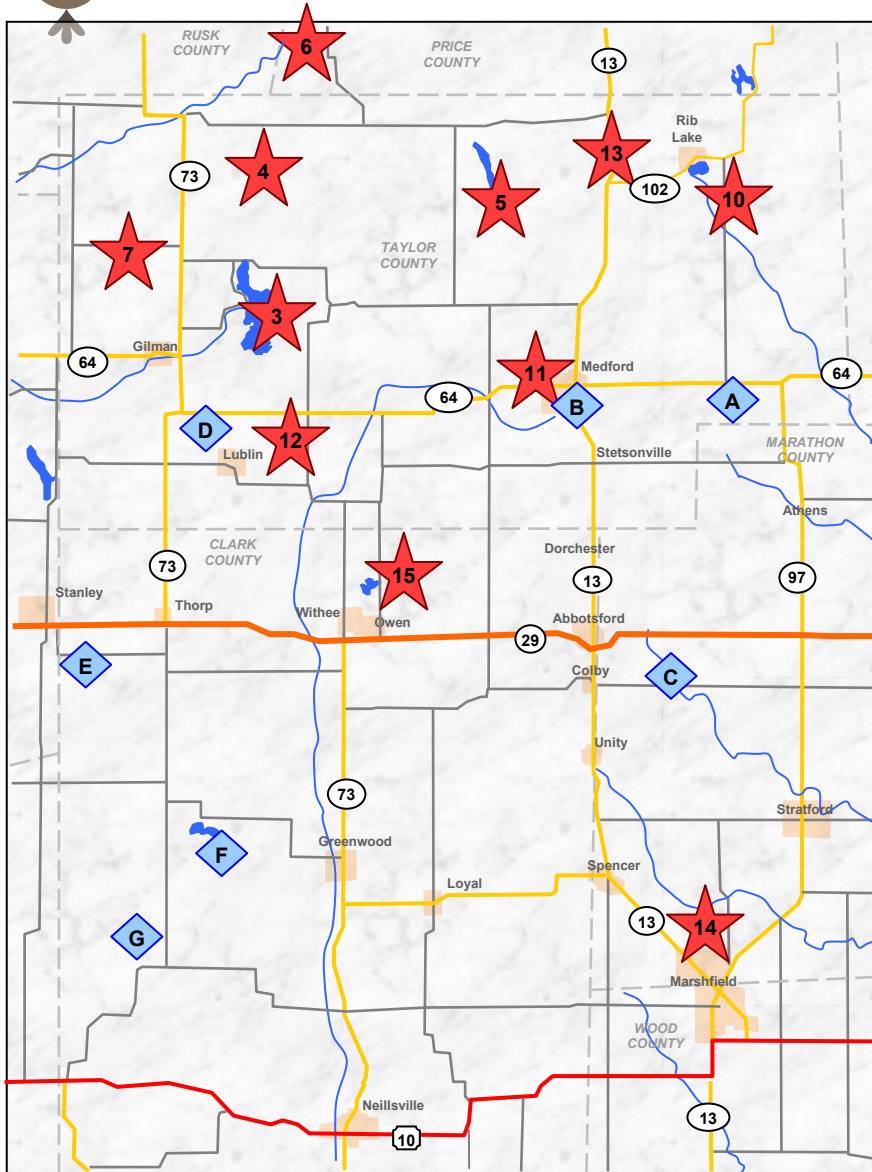

BIRDING HOTSPOTS

Page

- 3. Chequamegon Waters
- 4. Kidrick Swamp
- 5. Mondeaux Flowage
- 6. Steve Creek Flowage
- 7. Pershing Wildlife Area
- 10. Rib Lake Area
- 11. Medford Millpond & Riverwalk
- 12. Diamond Lake
- 13. Ice Age Trail
- 14. McMillan Marsh
- 15. Sportsman's Lake

Other area birding spots not covered in this booklet  :

- A. Medford School Forest
- B. Campus Woods and Trail
- C. Cherokee County Park
- D. Gilman School Forest
- E. Schmidt Maple Woods State Natural Area
- F. Mead Lake County Park
- G. Rock Dam Lake County Park

